

Singulair® (Montelukast Sodium)



□ 4mg granules



□ 4mg
chewable tablet



□ 5mg
chewable tablet



□ 10mg tablet



Reason for taking this medicine:

- To decrease the amount of mucus in the airways.
- This is a controller medicine and will not help if you are coughing, wheezing, or have shortness of breath.
- This is a medicine that must be used every day.
- This medicine may also be used to treat and control allergy symptoms.

How and when to take medicine:

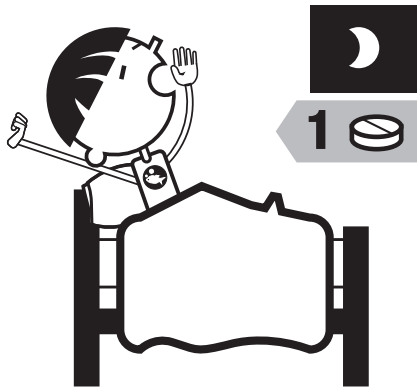

- Take 1 tablet by mouth 1 time a day in the evening.

Granules:

- ♦ Use 1 packet of granules 1 time a day in the evening.
- ♦ Granules can be poured directly into mouth.
- ♦ Granules can be added to a small amount (5mL) of formula or breast milk.
- ♦ Granules can be mixed with soft food such as:

Cooked Carrots

Applesauce

Ice cream

Rice

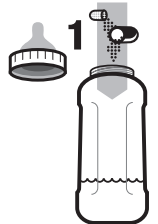

– Use the mixture within 15 minutes.

– Food should be cold or room temperature.

Possible side effects:

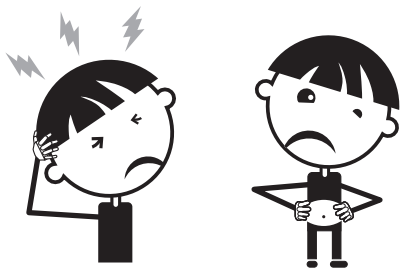

- Upset stomach
- Fever
- Stuffy nose
- Cough
- Headache

Call the doctor or clinic if:

- You have changes in your behavior or mood.
- You have flu-like symptoms.
- You have a rash.
- You have questions about this medicine or how to use it.

Important things to remember:

- If you suddenly have trouble breathing, use your rescue inhaler, albuterol.
- Singulair® may take up to a week before it starts to work.
– Use this medicine until your doctor tells you to stop.
- Do not use chewable tablets if you are allergic to phenylalanine or you have been diagnosed with PKU.

How to store:

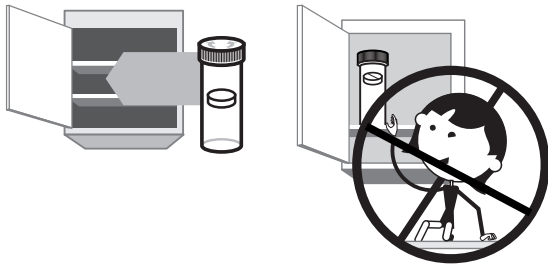

- Store in a cool dry cabinet.
- Do not store in bathroom.
- Keep out of reach of children.