



# Education Center Rental Guide







# Welcome to the Nationwide Children’s Hospital Education Center

Uniquely suited to host educational programs, meetings, symposia and classes for both professionals and the public, colleges and community groups, we offer an environment conducive to meet your learning needs.

From the first conversation to the day of your meeting, we are here to provide space and support services at fair rates to meet your program needs for both large and small groups. Located centrally in Columbus, Ohio, we offer easy access to parking, hotels, freeways and other amenities and attractions.

**Call us at (614) 355-0678 for a tour or more information about what we can provide to make your meeting special.**

**Amenities:**

- Free guest Wi-Fi
- Centrally located
- Convenient parking\*
- Handicapped accessible
- A/V technology and services\*
- On-site catering\*
- Room setup services\*

*\*Fees may apply.*

**For a quick virtual tour inside our Education Center, visit [bit.ly/NCHEdCenter](https://bit.ly/NCHEdCenter).**



# Parking



## Orange Parking Garage — 543 S. 18th Street, Columbus, OH 43205

The Orange Parking Garage is the designated parking for those attending events and conferences in the Education Center (subject to change). Visitors parking in the parking garage will be issued a time-stamped ticket when entering. Visitors can pay their parking fee inside the hospital by using the various “pay-on-foot” stations or as they exit. The cost is \$2 per exit.

# Driving Directions

## Coming from the...

### North

- Take 1-71 South to Main St. (Exit 108A)
- Keep right at the fork and merge onto E. Main St.
- Follow E. Main St. to S. 18th St.
- Turn right on S. 18th St. and cross over the bridge. The hospital and Orange Parking Garage will be on the right.

### South

- Take 1-71 North to I-70 East
- Take Exit 101B on the right
- At the Parsons Ave. traffic light, continue straight onto Mooberry St.
- Continue on Mooberry St. to the S. 18th St. intersection. At the traffic light, turn right onto S. 18th St.
- The hospital and Orange Parking Garage will be immediately on the right.

### East

- Take 1-70 West to Kelton Ave./Miller Ave. (Exit 102)
- Continue straight on Cole St. to S. Ohio Ave.
- Turn left onto S. Ohio Ave.
- Turn right onto Mooberry St.
- Turn left onto S. 18th St.
- The hospital and Orange Parking Garage will be immediately on the right.

### West

- Take I-70 East to 18th St. (Exit 101B)
- At the Parsons Ave. traffic light, continue straight onto Mooberry St.
- Continue on Mooberry St. to the S. 18th St. intersection. At the traffic light, turn right onto S. 18th St.
- The hospital and Orange Parking Garage will be immediately on the right.

## Floor Plan Diagrams

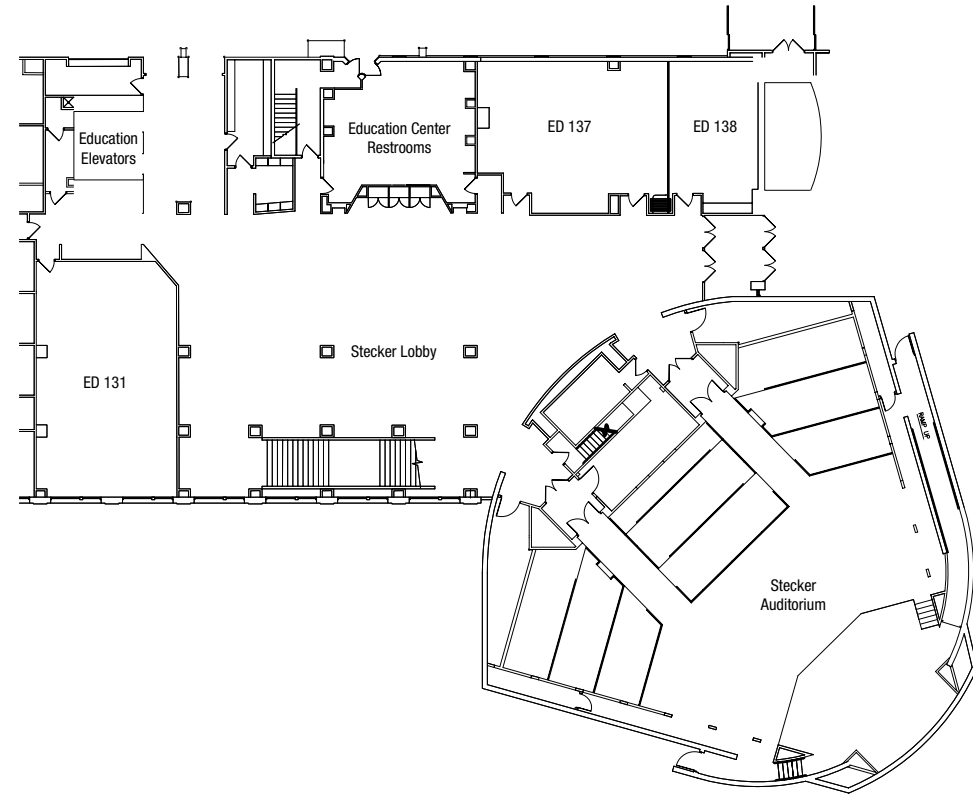

First Floor

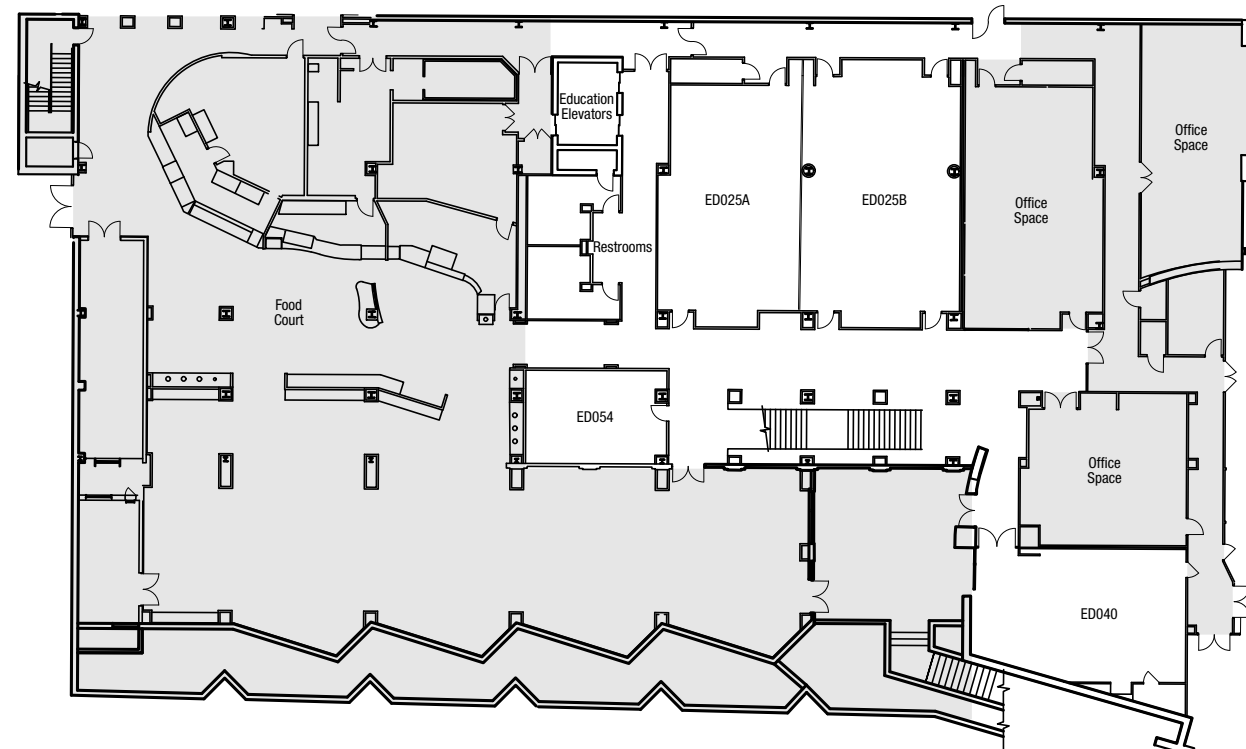

Lower Level

## Meeting Room Photos

ED 025A



ED 025B



ED 040





**ED 054**



**ED 138**



**ED 131**



**Stecker Auditorium — Classroom Set Up**



Stecker View Facing Stage

**ED 137**



Stecker View From Stage



# Meeting Room Capacity

## Education Center

Rooms	Setup	Capacity
025 A	Banquet/Rounds	84
025 B	Banquet/Rounds	98
025 A & B	Rounds	182
040	Classroom	48
054	Classroom	27
131	Classroom	60
137	Classroom	54
138	Classroom	24
137 & 138	Classroom	78
Stecker Auditorium	Classroom Theatre	250
	No Furniture	325





**NATIONWIDE  
CHILDREN'S®**

*When your child needs a hospital, everything matters.*